

# 24' x 120' Classroom



## Building Details:

Asset #: CR00208  
State Seal: NJ  
Building Size: 24 x 120  
Square Footage: 2880  
Occupancy: E - Education  
Roof Load: 20 PSF  
Wind Load: 90 MPH  
Floor Load: 100 PSF Lobbies and Corridors, 50 PSF Remainder  
Electrical: 3 Phase / 200 AMP Panel / 120/208 Volts

## Exterior Details:

Siding Material: .019 Aluminum  
Roofing Material: .045 EPDM  
Frame: Perimeter  
Doors: (5) Single  
Windows: (15) Vertical Slide  
HVAC: (4) 3 Ton / 10 kw Heat Strip

## Interior Details:

Wall Finish: F.R.P. Board over 1/2 inch Gypsum Board - Restrooms & Equipment Room, Vinyl Covered Gypsum - Remainder  
Floor Finish: Vinyl Block Tile & Roll Goods  
Lighting: Fluorescent  
Ceiling: Hard (Popcorn)  
Restroom: (1) Single, (2) Multi-Stall

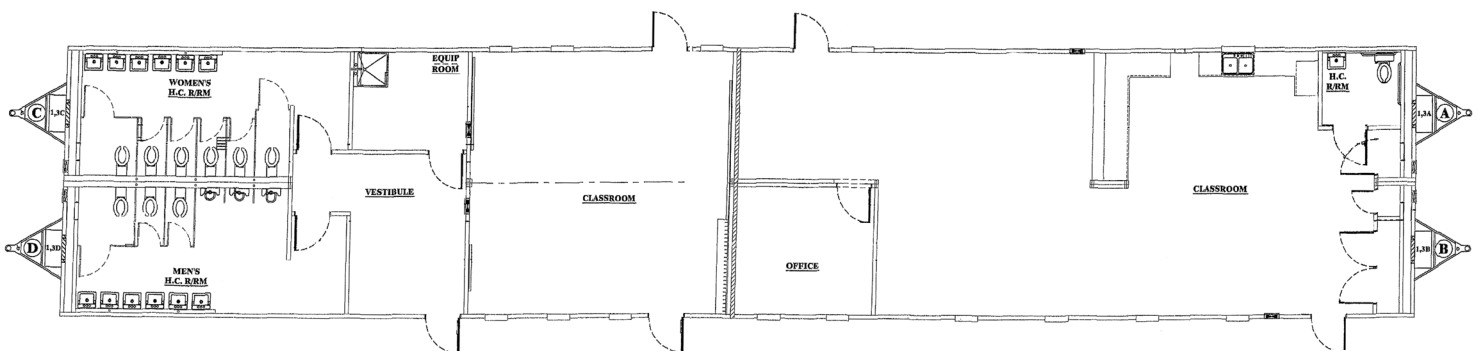

\*\*This building is subject to availability. The details provided are for informational purposes only and are not guaranteed. For detailed specifications, drawings and pricing contact your local representative.

## Contact:

Toll-free: 877.677.2231  
Phone: 732.223.4407  
Fax: 732.223.4458  
Email: [sales@mspaceholdings.com](mailto:sales@mspaceholdings.com)

## The M|SPACE Promise

You'll receive more industry expertise, more personal attention, and more financing options from M|SPACE than from any other modular space company.